

**KYORITSU PACKTEST INSTRUCTIONS**

# Copper

Model: WAK-Cu

## Bathocuproine Visual Colorimetric Method

Main Reagent: Bathocuproine

Measuring Range: 0.5 -  $\geq 10$  mg/L (ppm)

### How to Use

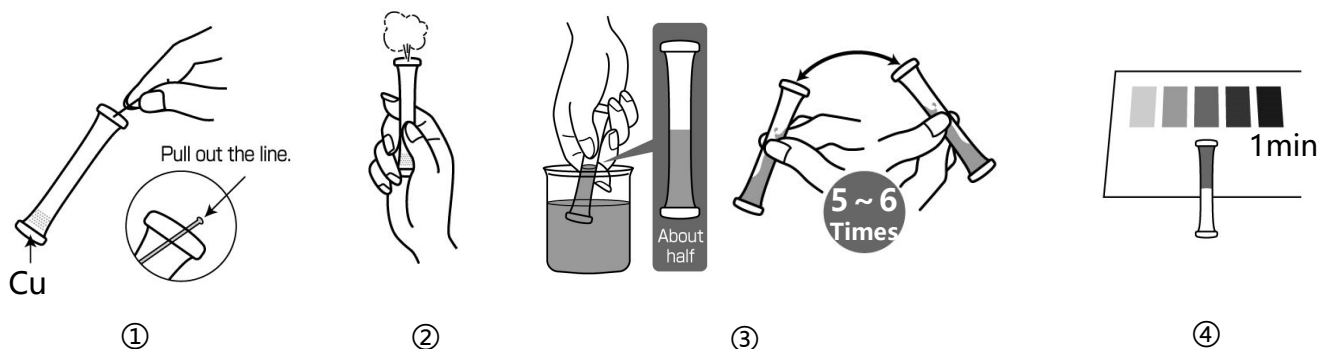

- ① Remove the colored line at the top of the tube to clear the aperture.
- ② Press the tube's side wall to expel air and hold the tube.
- ③ Immerse the aperture of the tube into the sample, release the finger to fill up the tube halfway. Invert the tube back and forth lightly for 5-6 times.
- ④ After 1min, place the tube on the provided Color Sheet as shown to compare the color.

### How to Read the Result

After the reaction time, compare the color of the tube with Standard Color. The nearest color indicates the concentration value of the analyte in your sample. A color between two standard colors indicate the value between them.

### Handling of PACKTEST Before and After Use

#### First Aid

**Eye Contact** → Immediately flush eyes with plenty of water.

**Skin/Cloth Contact** → Immediately flush contacted area with water.

**Ingestion** → Immediately rinse mouth.

If swallowed the content or any symptom appears, seek medical advice immediately. Please refer to SDS for further information.

#### Storage

Keep unused PACKTEST tubes in the provided preserving bag after opening the laminated package and use them as soon as possible. Depending on the storage condition, the reagent may deteriorate in several days especially under the hot and humid weather.

#### Disposal

For business use, please follow in the manner consistent with relevant laws and regulations. Otherwise, the tube can be disposed as combustible waste.

## PACKTEST Copper

### Caution

1. This product allows to measure Copper ion ( $\text{Cu}^+$ ,  $\text{Cu}^{2+}$ ) in the sample. If the value including turbidity, precipitation, and complex are required, please dissolve them prior to use.
2. The optimum pH upon reaction will be around 6. If the pH of the sample exceeds 2-10, please neutralize with dilute sodium hydroxide solution or dilute sulfuric acid prior to measurement.
3. A copper standard solution of 1000 mg/L or more develops a color similar or darker than  $\geq 10$  on the Standard Color. When the value is expected to be high, please dilute the sample prior to use.
4. Ensure that the PACKTEST tube is filled up to half.
5. Partially undissolved reagent will not affect the measurement.
6. Keep the sample temperature between 15-40°C.
7. When comparing to the Standard Color, please be sure to read under the daylight. It may be difficult to determine the color under the direct sunlight, certain florescent lights, mercury lamp or LED.
8. You can put the line back into the aperture to seal. This will avoid possibility of spilling the content of the tube.

### Interference

Standard Color is prepared based on the standard solution. If there are some coexisting substances that may cause interference, please compare the result with official method or standard addition method for verification. Below is the list of interference data for a color development when adding each of the single substance to the standard solution.

$\leq 1000\text{mg/L}$	will not affect	... B(III), $\text{Ba}^{2+}$ , $\text{Ca}^{2+}$ , $\text{Cl}^-$ , $\text{F}^-$ , $\text{I}^-$ , $\text{K}^+$ , $\text{Mg}^{2+}$ , Mo(VI), $\text{Na}^+$ , $\text{NH}_4^+$ , $\text{NO}_2^-$ , $\text{NO}_3^-$ , $\text{PO}_4^{3-}$ , $\text{SO}_3^{2-}$ , $\text{SO}_4^{2-}$ , $\text{Zn}^{2+}$ , Anionic Surfactant, Residual Chlorine, Phenol
$\leq 500\text{mg/L}$	"	... $\text{Mn}^{2+}$
$\leq 250\text{mg/L}$	"	... $\text{Ni}^{2+}$
$\leq 100\text{mg/L}$	"	... $\text{Al}^{3+}$ , $\text{Co}^{2+}$ , $\text{Cr}^{3+}$
$\leq 50\text{mg/L}$	"	... $\text{Fe}^{2+}$ , $\text{Fe}^{3+}$
$\leq 20\text{mg/L}$	"	... Cr(VI)
$\leq 10\text{mg/L}$	"	... $\text{Ag}^+$
$\leq 5\text{mg/L}$	"	... $\text{CN}^-$

Seawater does not affect the result.

Oxidizing substances may affect the result.

## **【Caution】**

- This product is made for analyzing water quality purpose only. Do not use for any other purpose.
  - This product contains small amount of chemicals. Please read instruction manual, GHS labels, SDS, and other necessary document thoroughly prior to use.
  - Please keep this information handy for future reference.
- <Safety>
- Please wash your hands thoroughly before and after the test. Do not inhale the chemical reagents.
    - It is highly recommended to wear protective gloves, eye protection, and mask upon using this product.
    - Avoid release chemical reagents or waste solution to the environment.
- <Storage>
- Please keep this product out of reach of children. Keep it in the dry and dark place at room temperature.
- <Other>
- Please check the expiration date shown on the box, and make sure to use within the date.
    - Specifications are subject to change without notice.



**KYORITSU**  
CHEMICAL-CHECK Lab., Corp.

1-18-2 Hakusan, Midori-ku, Yokohama, Kanagawa  
226-0006, JAPAN E-mail:eng@kyoritsu-lab.co.jp

2102