

KYORITSU PACKTEST INSTRUCTIONS

Hydrogen Peroxide

Model: WAK-H₂O₂

4-Aminoantipyrine Visual Colorimetric Method with Enzyme

Main Reagent: Enzyme, 4-Aminoantipyrine
 Measuring Range: 0.05 – 5 mg/L (ppm)

How to Use

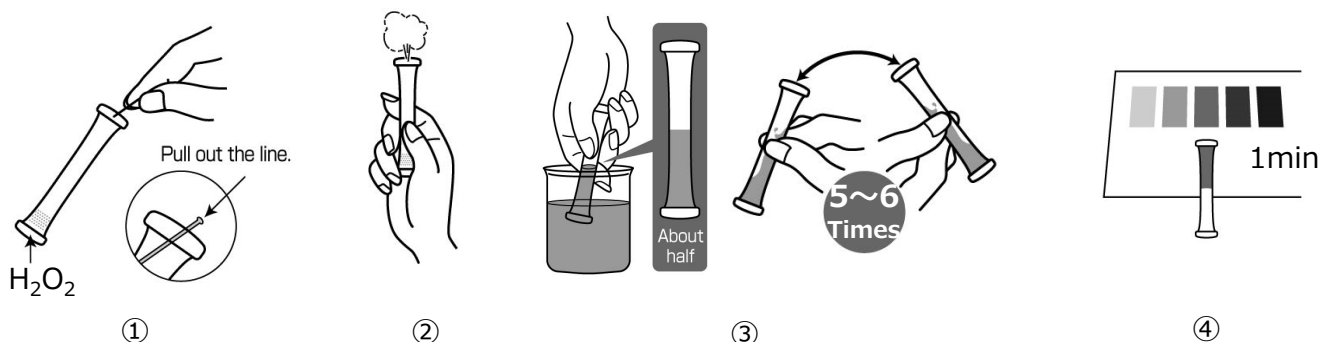

- ① Remove the colored line at the top of the tube to clear the aperture.
- ② Press the tube's side wall to expel air and hold the tube.
- ③ Immerse the aperture of the tube into the sample, release the finger to fill up the tube halfway. Invert the tube back and forth lightly for 5-6 times.
- ④ After 1min, place the tube on the provided Standard Color as shown to compare the color.

How to Read the Result

After the reaction time, compare the color of the tube with Standard Color. The nearest color indicates the concentration value of the analyte in your sample. A color between two standard colors indicate the value between them.

Handling of PACKTEST Before and After Use

First Aid

Eye Contact → Immediately flush eyes with plenty of water.
Skin/Cloth Contact → Immediately flush contacted area with water.
Ingestion → Immediately rinse mouth.

If swallowed the content or any symptom appears, seek medical advice immediately.
 Please refer to SDS for further information.

Storage

Use PACKTEST tubes as soon as possible after opening the laminated package. Reagents are relatively heat-sensitive. Please avoid high temperature and humidity.

Disposal

For business use, please follow in the manner consistent with relevant laws and regulations. Otherwise, the tube can be disposed as combustible waste.

PACKTEST Hydrogen Peroxide

Caution

1. If the sample contains higher than 25 mg/L of hydrogen peroxide, the color will fade as the concentration increases. For example, the color will turn 1 on the Standard Color at 100 mg/L. If high concentrations are expected, dilute in advance before measurement.
2. The optimum pH upon reaction will be around 7. If the pH of the sample exceeds 6-9, please neutralize with dilute sodium hydroxide solution or dilute sulfuric acid prior to measurement.
3. Keep the sample temperature between 15-40°C. If the sample temperature is low, it requires longer reaction time.
4. Ensure that the PACKTEST tube is filled up to half.
5. Partially undissolved reagent will not affect the measurement.
6. When comparing to the Standard Color, please be sure to read under the daylight. It may be difficult to determine the color under the direct sunlight, certain florescent lights, mercury lamp or LED.
7. You can put the line back into the aperture to seal. This will avoid possibility of spilling the content of the tube.

Interference

Standard Color is prepared based on the standard solution. If there are some coexisting substances that may cause interference, please compare the result with official method or standard addition method for verification. Below is the list of interference data for a color development when adding each of the single substances to the standard solution.

| | | |
|-----------|-----------------|--|
| ≤1000mg/L | will not affect | ... Ag ⁺ , B(III), Ba ²⁺ , Ca ²⁺ , Cl ⁻ , F ⁻ , I ⁻ , K ⁺ , Mg ²⁺ , Na ⁺ , NH ₄ ⁺ , NO ₃ ⁻ , PO ₄ ³⁻ , SO ₄ ²⁻ , Zn ²⁺ |
| ≤500mg/L | " | ... NO ₂ ⁻ , Phenol |
| ≤200mg/L | " | ... Ni ²⁺ |
| ≤100mg/L | " | ... Al ³⁺ , Cr ³⁺ , Anionic Surfactant |
| ≤50mg/L | " | ... Cu ²⁺ |
| ≤20mg/L | " | ... Co ²⁺ , Mn ²⁺ |
| ≤5mg/L | " | ... Cr(VI) |
| ≤2mg/L | " | ... Mo(VI) |
| ≤1mg/L | " | ... CN ⁻ , Fe ³⁺ |
| Any Level | will affect | ... Fe ²⁺ , Residual Chlorine |

Seawater does not affect the result.

Oxidative substances like Residual Chlorine or Dissolved Ozone may develop color and cause false positive reading.

If residual chlorine exist by itself, the color turns 0.1 of Standard Color when Cl is at 1mg/L and turns 0.05 of Standard Color when Cl is at 0.5mg/L.

Hydrogen peroxide is consumed by reducing substances.

【Caution】

- This product is made for analyzing water quality purpose only. Do not use for any other purpose.
 - This product contains small amount of chemicals. Please read instruction manual, GHS labels, SDS, and other necessary document thoroughly prior to use.
 - Please keep this information handy for future reference.
- <Safety>
- Please wash your hands thoroughly before and after the test. Do not inhale the chemical reagents.
 - It is highly recommended to wear protective gloves, eye protection, and mask upon using this product.
 - Avoid release chemical reagents or waste solution to the environment.
- <Storage>
- Please keep this product out of reach of children. Keep it in the dry and dark place at room temperature.
- <Other>
- Please check the expiration date shown on the box, and make sure to use within the date.
 - Specifications are subject to change without notice.



KYORITSU
CHEMICAL-CHECK Lab., Corp.

1-18-2 Hakusan, Midori-ku, Yokohama, Kanagawa
226-0006, JAPAN E-mail:eng@kyoritsu-lab.co.jp

2102