

Phosphate

(Low Range)

Model : WAK-PO₄ (D)

4-Aminoantipyrine Visual Colorimetric Method with Enzyme

Measuring Range: Phosphate Ion 0.05 - 2mg/L(ppm)
Phosphate-Phosphorus 0.02 - 1mg/L(ppm)

How to Use

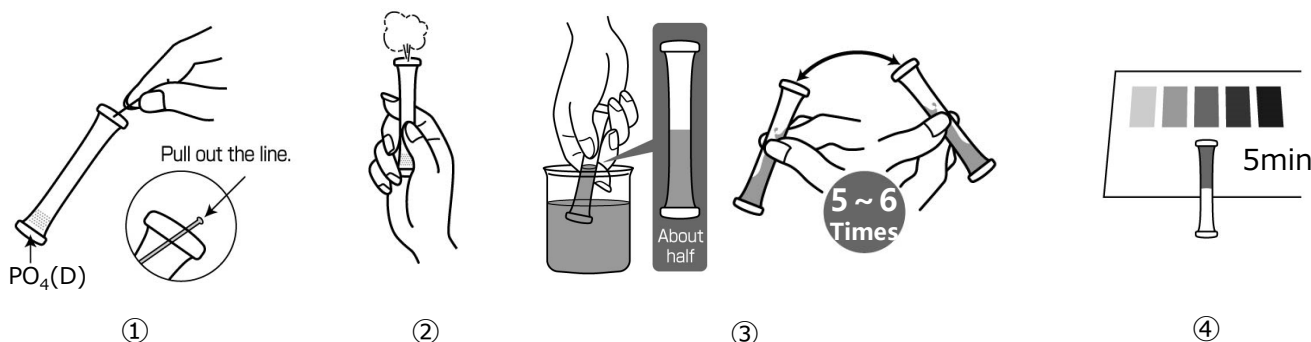

- ① Remove the colored line at the top of the tube to clear the aperture.
- ② Press the tube's side wall to expel air and hold the tube.
- ③ Immerse the aperture of the tube into the sample, release the finger to fill up the tube halfway. Invert the tube back and forth lightly for 5-6 times.
- ④ After 5min, place the tube on the provided Color Sheet as shown to compare the color.

How to Read the Result

After the reaction time, compare the color of the tube with Standard Color. The nearest color indicates the concentration value of the analyte in your sample. A color between two standard colors indicate the value between them.

Standard Color has Phosphate and Phosphate-Phosphorus printed on each side. Please use them accordingly.

Handling of PACKTEST Before and After Use

First Aid

Eye Contact → Immediately flush eyes with plenty of water.

Skin/Cloth Contact → Immediately flush contacted area with water.

Ingestion → Immediately rinse mouth.

If swallowed the content or any symptom appears, seek medical advice immediately.
Please refer to SDS for further information.

Storage

Keep unused PACKTEST tubes in the provided preserving bag after opening the laminated package and use them as soon as possible. The reagent is relatively heat-sensitive. Be careful of high temperature above 30°C and high humidity. When exposed to high temperature (above 35°C) for a long time, color development becomes weak.

Disposal

For business use, please follow in the manner consistent with relevant laws and regulations.
Otherwise, the tube can be disposed as combustible waste.

PACKTEST Phosphate (Low Range)

Caution

1. With this method, only phosphate ions in the sample water can be measured, and hydrolyzable phosphorus and total phosphorus cannot be measured.
2. This product provides both measurement for phosphate ion and phosphate phosphorus in the sample water.
3. The optimum pH upon reaction will be around 7. If the pH of the sample exceeds 6-9, please neutralize with dilute sodium hydroxide solution or dilute sulfuric acid prior to measurement.
4. A Phosphate standard solution of 1000mg/L develops a color stronger than "2" on the Standard Color. When the value is expected to be high, please dilute the sample prior to use.
5. Keep the sample temperature between 15-40°C.
6. Ensure that the PACKTEST tube is filled up to half.
7. Partially undissolved reagent will not affect the measurement.
8. When comparing to the Standard Color, please be sure to read under the daylight. It may be difficult to determine the color under the direct sunlight, certain florescent lights, mercury lamp or LED.
9. You can put the line back into the aperture to seal. This will avoid possibility of spilling the content of the tube.

Interference

Standard Color is prepared based on the standard solution. If there are some coexisting substances that may cause interference, please compare the result with official method or standard addition method for verification. Below is the list of interference data for a color development when adding each of the single substance to the standard solution.

≤1000mg/L	will not affect	...	Ba ²⁺ , Ca ²⁺ , Cl ⁻ , F ⁻ , I ⁻ , K ⁺ , Na ⁺ , NH ₄ ⁺ , NO ₂ ⁻ , NO ₃ ⁻
≤500mg/L	"	...	B(III), Phenol
≤200mg/L	"	...	Zn ²⁺
≤50mg/L	"	...	Cu ²⁺ , Mg ²⁺ , Ni ²⁺ , SO ₄ ²⁻
≤10mg/L	"	...	Al ³⁺ , Cr ³⁺ , Cr(VI), Mn ²⁺
≤5mg/L	"	...	Fe ³⁺
≤1mg/L	"	...	CN ⁻
Any Level	will affect	...	Fe ²⁺ , Residual Chlorine

Not suitable for measuring the seawater.

Oxidizing substances, like Residual Chlorine and Hydrogen Peroxide, may develop color and affect the result. e.g., 1mg/L of Residual Chlorine causes the equivalent color development around 0.15mg/L of Phosphate.

Reducing substances may weaken the color development.

【Caution】

- This product is made for analyzing water quality purpose only. Do not use for any other purpose.
 - This product contains small amount of chemicals. Please read instruction manual, GHS labels, SDS, and other necessary document thoroughly prior to use.
 - Please keep this information handy for future reference.
- <Safety>
- Please wash your hands thoroughly before and after the test. Do not inhale the chemical reagents.
 - It is highly recommended to wear protective gloves, eye protection, and mask upon using this product.
 - Avoid release chemical reagents or waste solution to the environment.
- <Storage>
- Please keep this product out of reach of children. Keep it in the dry and dark place at room temperature.
- <Other>
- Please check the expiration date shown on the box, and make sure to use within the date.
 - Specifications are subject to change without notice.



KYORITSU
CHEMICAL-CHECK Lab., Corp.

1-18-2 Hakusan, Midori-ku, Yokohama, Kanagawa
226-0006, JAPAN E-mail:eng@kyoritsu-lab.co.jp

2102