

Sulfite (High Range)

Iodine Visual Colorimetric Method

Main Reagent: Iodate

Model : WAK-SO₃ (C)

Measuring Range: 50 - 2000 mg/L (ppm)

How to Use

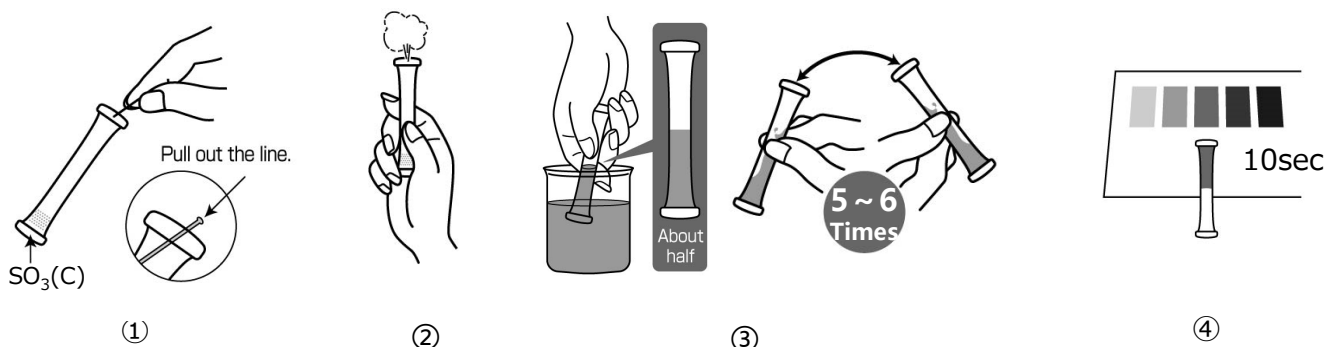

- ① Remove the colored line at the top of the tube to clear the aperture.
- ② Press the tube's side wall to expel air and hold the tube.
- ③ Immerse the aperture of the tube into the sample, release the finger to fill up the tube halfway. Invert the tube back and forth lightly for 5-6 times.
- ④ After 10sec, place the tube on the provided Standard Color as shown to compare the color.

How to Read the Result

After the reaction time, compare the color of the tube with Standard Color. The nearest color indicates the concentration value of the analyte in your sample. A color between two standard colors indicate the value between them.

Handling of PACKTEST Before and After Use

The content of the tube is **Strong Acid**.

First Aid

Eye Contact → Immediately flush eyes with water for at least 15 minutes, followed by consult with Ophthalmologist, even without any symptom.

Skin/Cloth Contact → Immediately flush contacted area with water.

Ingestion → Immediately rinse mouth.

If swallowed the content or any symptom appears, seek medical advice immediately. Please refer to SDS for further information.

Storage

After opening the laminated package and use them as soon as possible.

Disposal

For business use, please follow in the manner consistent with relevant laws and regulations. Otherwise, the tube can be disposed as combustible waste.

PACKTEST Sulfite (High Range)

Caution

1. Sulfite ions are quickly oxidized in contact with air, so please follow the procedure immediately after taking the sample.
2. The test result must be read between 10sec and 1 min. If taking more than 1min, it becomes black and the PACKTEST tube stains to purple.
3. The optimum pH upon reaction will be ≤ 2 . If the pH of the sample exceeds 9, please use dilute sulfuric acid to bring pH down to ≤ 7 prior to measurement.
4. It is dangerous to measure sample exceeding stated measuring range, because it generates bubbles. When the value is expected to be high, please dilute the sample prior to use.
5. Ensure that the PACKTEST tube is filled up to half.
6. Partially undissolved reagent will not affect the measurement.
7. Keep the sample temperature between 15-40°C. If the sample temperature is low, it requires longer reaction time.
8. When comparing to the Standard Color, please be sure to read under the daylight. It may be difficult to determine the color under the direct sunlight, certain florescent lights, mercury lamp or LED.
9. You can put the line back into the aperture to seal. This will avoid possibility of spilling the content of the tube.

Interference

Standard Color is prepared based on the standard solution. If there are some coexisting substances that may cause interference, please compare the result with official method or standard addition method for verification. Below is the list of interference data for a color development when adding each of the single substance to the standard solution.

$\leq 1000\text{mg/L}$	will not affect	...	Al^{3+} , Ca^{2+} , Cl^- , K^+ , Mg^{2+} , Na^+ , NH_4^+ , Ni^{2+} , NO_3^- , PO_4^{3-} , SO_4^{2-} , Anionic surfactant, Formaldehyde
$\leq 100\text{mg/L}$	"	...	Cu^{2+} , Zn^{2+}
$\leq 20\text{mg/L}$	"	...	NO_2^-
$\leq 10\text{mg/L}$	"	...	Fe^{2+} , Fe^{3+}

Not suitable for measuring the seawater.

If sample contains Starch, iodide reacts and develops color from purple to black.

Reducing substances may develop stronger color depending on the reducing strength.

Oxidizing substances may weaken the color development for false negative reading.

【Caution】

- This product is made for analyzing water quality purpose only. Do not use for any other purpose.
 - This product contains small amount of chemicals. Please read instruction manual, GHS labels, SDS, and other necessary document thoroughly prior to use.
 - Please keep this information handy for future reference.
- <Safety>
- Please wash your hands thoroughly before and after the test. Do not inhale the chemical reagents.
 - It is highly recommended to wear protective gloves, eye protection, and mask upon using this product.
 - Avoid release chemical reagents or waste solution to the environment.
- <Storage>
- Please keep this product out of reach of children. Keep it in the dry and dark place at room temperature.
- <Other>
- Please check the expiration date shown on the box, and make sure to use within the date.
 - Specifications are subject to change without notice.



KYORITSU
CHEMICAL-CHECK Lab., Corp.

1-18-2 Hakusan, Midori-ku, Yokohama, Kanagawa
226-0006, JAPAN E-mail:eng@kyoritsu-lab.co.jp

2102